

SPRING ASSIST

FABRICATION INSTRUCTIONS

fabritec
DESIGNS

1. SELECT CORRECT PARTS

Using the Shade Fabrication Calculator on rolleaseacmeda.com, select the clutch and tube required for your project. Select Left or Right hand clutch operation as you must use a different clutch for each. Assumes back roll roller shade. For front-roll shades see notes below.

LEFT-HAND clutch operation has a BLUE label on the clutch housing. The **RIGHT-HAND** clutch has a RED label.

2. INSTALL BEAD CHAIN

For ease of installation, a bead chain drop length of at least 50 inches should be used to allow the chain to clear the spring assist assembly. If a shorter chain is ever required, the open loop should be installed into the clutch before the bead chain is connected.

3. PRE-WIND SPRING

Using the Shade Fabrication Calculator on rolleaseacmeda.com, after entering your fabric and tube selections, select the **Spring Assist Clutch** from the **Clutch** drop down menu and the calculator will show the number of rotations you must pre-wind into the spring. Holding the clutch as shown in figures 3A & 3B, pull on the rear chain so the housing and spring assist assembly rotates in the direction of the arrow on the red or blue sticker attached to the clutch housing.

Count complete revolutions corresponding to the width versus drop length obtained from the provided chart.

4. INSTALL SOUND REDUCING FOAM

On shade tubes with internal features (keyed tube), the end of the Spring Assist mechanism may rub against the key while the tube is rotating causing a knocking effect. To prevent this it is recommended that an approximately 1-foot (305 mm) section of common plumbing hot/cold water pipe insulation foam be taped to the black sleeve on the end of the Spring Assist. (Use foam sleeve that fits 1" (25mm) copper pipes or 3/4" (75mm) iron pipes). Note: The foam sleeve must be secured to the black PVC sleeve only and should never be attached to the spring, white spring-retainer or square metal shaft.

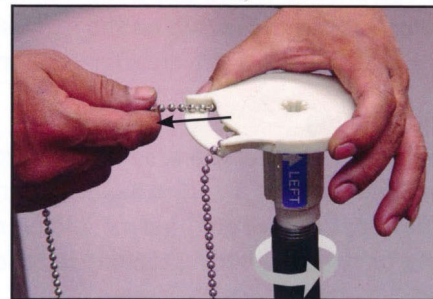
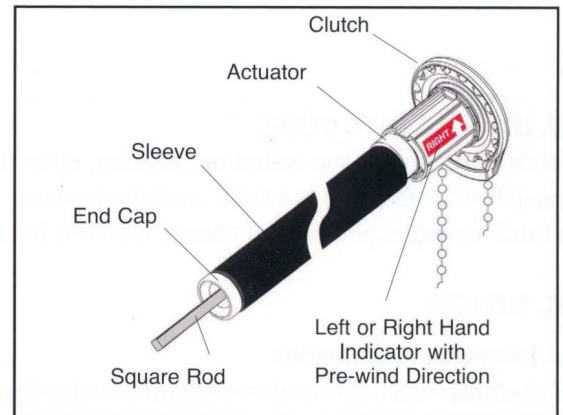

Figure 3A "Left" Blue Label Pre-Rotate in direction of arrow

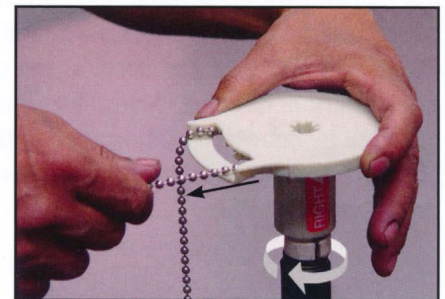
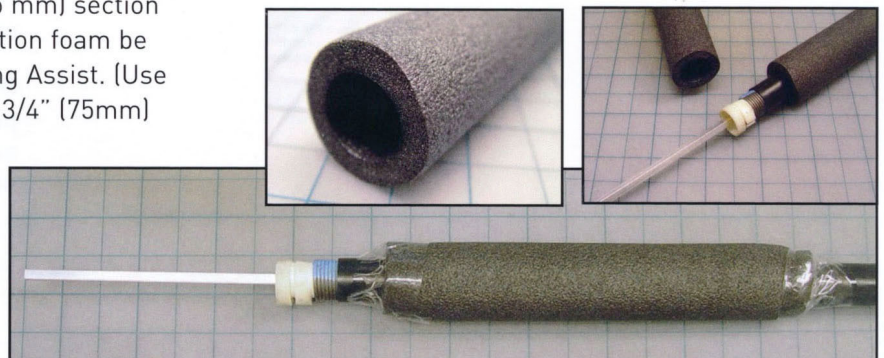

Figure 3B "Right" Red Label Pre-Rotate in direction of arrow



(continued on back)

Leading innovator of precision hardware and automated shade solutions.

USA | AUSTRALIA | EUROPE rolleaseacmeda.com

30 Nov 2015

© Rollease Acmeda Inc.



**ROLLEASE
ACMEDA**
PRECISION IN MOTION

SPRING ASSIST

FABRICATION INSTRUCTIONS CONTINUED

fabritec
DESIGNS

5. INSTALL INTO TUBE

With the shade in the rolled up position, slide the spring assist assembly into the tube until the housing on the clutch engages and is fully seated with the tube.

6. NOTES

A.) Reverse Roll Shades

Assembly instructions above assume a standard roll roller shade. Front roll shades must be assembled differently. For reverse roll shades (only), use a right-hand clutch on the left side or a left-hand clutch on the right side. Pre-rotations should still follow the direction the arrow indicates.

B.) Re-setting Spring

If it ever becomes necessary to reset the spring assist to zero tension (ie: changing a spring assist roller shade for use in another application, etc.) before adding additional pre-rotations be sure the spring tension is reset to zero.

How to tell if spring is at zero tension: Hold the clutch by the housing with one hand and with the other move the cord guard and release. If the cord guard stays in it's position the spring is virtually at zero. If the cord guard snaps back, adjustment is needed. Manually adjust as close to "zero" as possible by counter rotating the bead chain which rotates the spring in the opposite direction of the arrow. Test and adjust until spring is at zero.

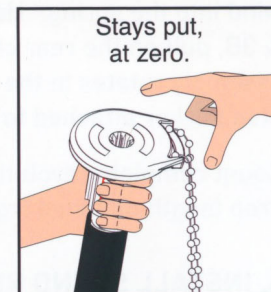
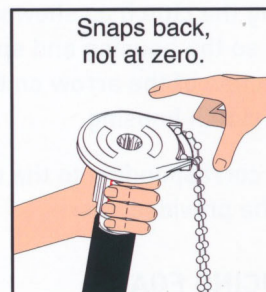
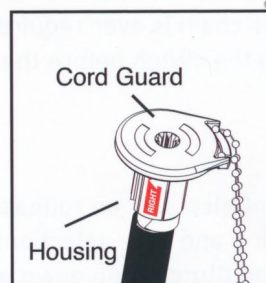
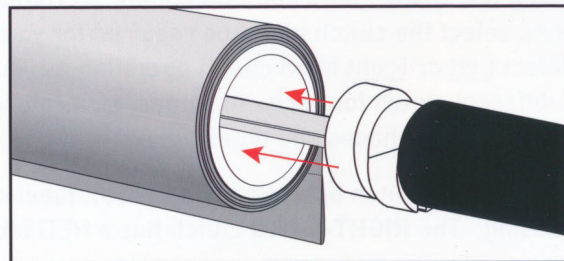

Note: Illustration shown for right-hand clutches, left hand clutches will snap back in the opposite direction.

Once the spring has returned to zero, use the pre-rotation chart, and pre-wind the spring according to the requirements of the new application.

Fabritec, LLC. | 7531 Coldwater Canyon Avenue | North Hollywood | CA, 91605 | t 818.503.8300 | f 818.503.8360 | www.fabritecdesigns.com

Leading innovator of precision hardware and automated shade solutions.

USA | AUSTRALIA | EUROPE rolleaseacmeda.com

30 Nov 2015

© Rollease Acmeda Inc.



**ROLLEASE
ACMEDA**
PRECISION IN MOTION