

Safe and Silent Solutions
for Roller Shades

SMARTROLL™ 32-1

INSTALLATION INSTRUCTIONS



Roller Shades

INSTALLATION INSTRUCTIONS ~ SMARTROLL™ 32-1

Thank you for purchasing your new Smartroll shades. They have been custom-made from the highest quality materials to the dimensions you specified. With the proper installation and care, it will provide you with many years of beauty and trouble-free use.

Please read all instructions before you start so you will be familiar with the overall process.

Make sure you measure your window to ensure the shade will fit properly before beginning.

Getting Started

Remove the Smartroll shades from the packaging. Keep the packaging until you have successfully installed the shades.

TOOLS REQUIRED

- Pencil
- Awl
- Tape Measure
- Level
- Ladder or Stepstool
- Power Drill with the following bits:
 - 1/16" Drill Bit
 - 1/4" Hex Driver
 - Standard Screwdriver
 - Masonry Drill Bit (if drilling into concrete or brick)

FASTENER NOTES

For outside mount, it is best to attach the bracket to wood studs. If this is not possible, you will need to purchase special fasteners (see illustration below for examples).

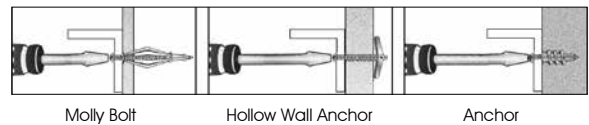

Here are some HELPFUL TIPS:

- If you are using a special fastener, make sure it is designed to support the weight of the shades. Follow the fastener manufacturer's instructions carefully.
- When drilling into drywall or plaster, use a fastener designed for hollow wall applications (see illustration).
- When drilling into concrete, stone, brick, or tile, use appropriate plugs, anchors, or screws (not included).
- When drilling into metal, the included screws are sufficient. Pre-drill 1/8" holes.

BEFORE YOU BEGIN, VERIFY THAT YOU HAVE ALL THE NECESSARY PARTS AND PIECES:

• **SHADES - NOTE THE SHADE SIZE. THIS IS VERY IMPORTANT.**

For shade sizes less than 36 $\frac{7}{8}$ " tip to tip wide, refer to the installation instructions for Smartroll™ 24-1.

For shade sizes greater than 36 $\frac{7}{8}$ " tip to tip wide, refer to the installation instructions for Smartroll™ 32-1.

- **PACKAGE** - Contains 2 brackets (a left bracket and a right bracket), 2 bracket covers, 4 mounting screws and a stop pin.

PACKAGE CONTENTS

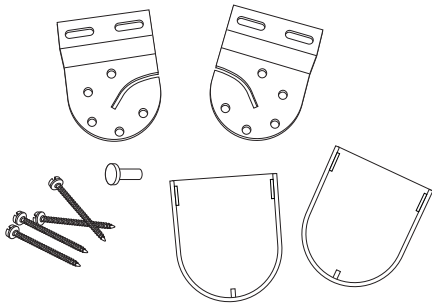

Illustrations, clockwise from top left:
End brackets (right and left sides), end caps,
stop pin and installation screws.

If this Smartroll technology is new to you, or you have never installed a Smartroll shade before, please go to the [YouTube](https://www.youtube.com/watch?v=...) video at: www.smartroll.com

Scroll down to the "Technological Innovation" section and you will see the video for the "Smartroll 32-1 Installation Tour" on the right side.

Pay particular attention to Steps 2/7 through 7/7 in this video. Step 1/7 has already been completed at the factory.

NOTE:

The following directions are based on a standard roll shade. For a reverse roll shade, simply turn the shade around.

The spring drive wheel for a standard shade installation will be on the right side and the brake wheel will be on the left side.

If the shade is turned around, the spring drive wheel will be on the left side and the brake wheel will be on the right side.

Mounting the Shades

STEP 1 - BRACKET INSTALLATION.

Attach the brackets to the wall. Use a pencil to mark the drilling points and a level to keep a proper horizontal position.

Attach them to the wall with the 4 screws provided. See photos below.

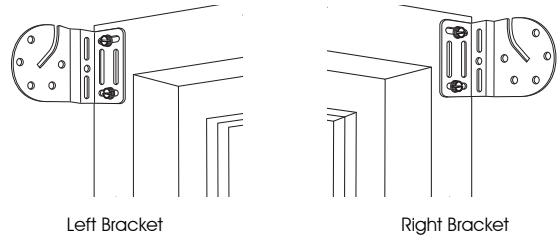

Left Bracket

Right Bracket

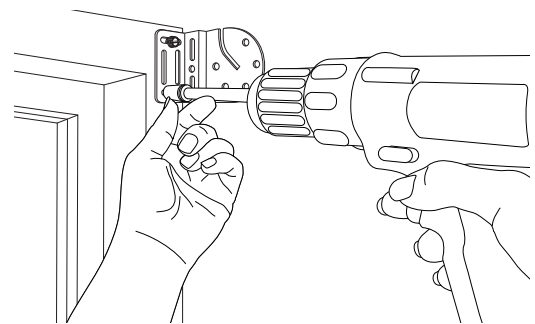

Attaching right bracket to wall

STEP 2 - ROLLER SHADE INSTALLATION.

Attach the roller shade to the brackets by slipping the pins into the notches.

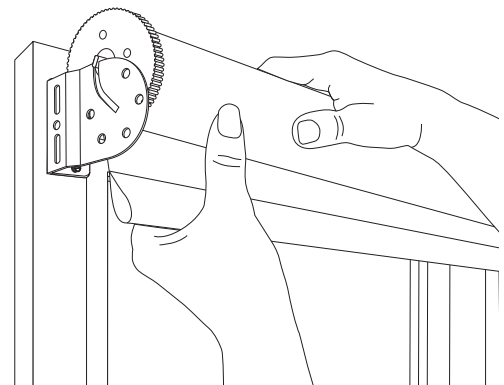

Left end of spring drive wheel

STEP 2 - ROLLER SHADE INSTALLATION (continued).

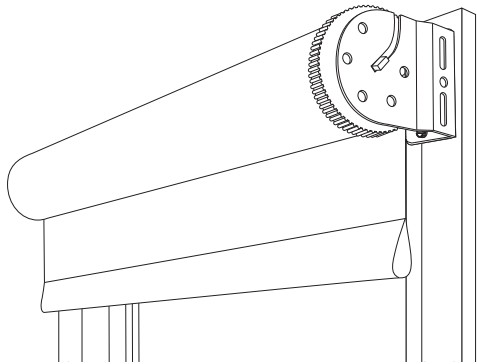

Right end of spring drive wheel with pin in notch

STEP 3 - ADJUST THE SHADE SPEED (continued).

Note: There is a flat surface on the wheel to help in counting of the revolutions. If the tension is too tight, lift the *right pin* only out of the bracket, and the tension will release.

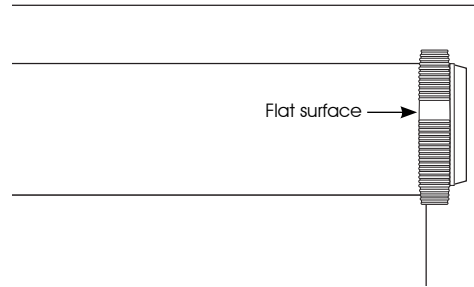

Flat surface on wheel
(to help in counting the revolutions)

STEP 3 - ADJUST THE SHADE SPEED.

Adjust the speed at which the shade will rise. The shade speed is set at the factory. However, the selected speed may be too slow or the tension may have loosened during shipping.

To make an adjustment, locate the spring drive wheel on the right side of the shade. Hold shade with the left hand and turn the spring drive wheel counter-clockwise. This will tighten the tension on the shade to help it roll faster.

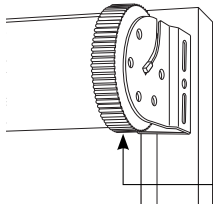

IMPORTANT!
DO NOT TURN the
wheel more than
21 FULL REVOLUTIONS.

Right side, spring drive wheel

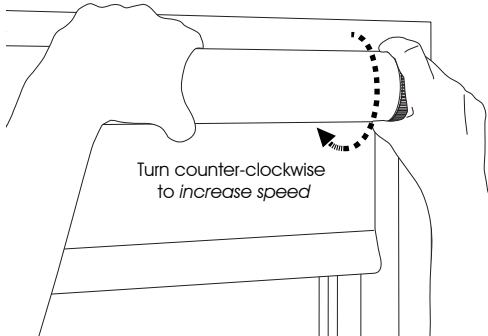

Turn counter-clockwise
to increase speed

Rotating the spring drive wheel counterclockwise

STEP 4 - SETTING THE UPPER LIMIT STOP.

This is the location where the shade will stop when raised.

Simply raise the shade to the desired stopping location by turning the brake wheel on the left side of the shade. Nothing more is required.

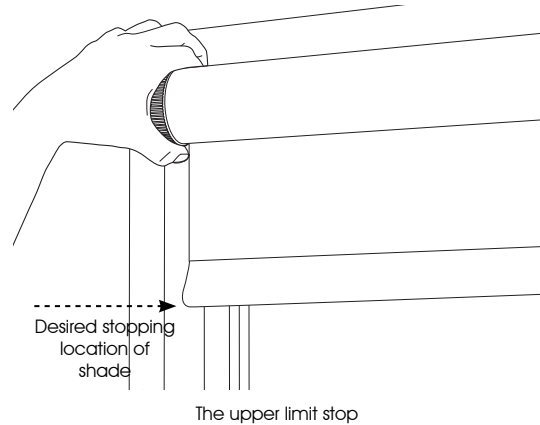

Desired stopping
location of
shade

The upper limit stop

STEP 5 - ALIGN THE HOLES.

There are 5 holes at the end of the brake wheel. Rotate the shade until the holes line up with the holes on the bracket.

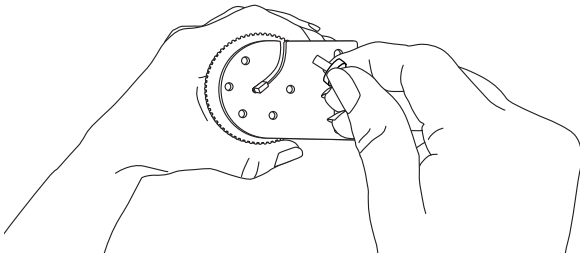

STEP 6 - INSERT THE STOP PIN.

Secure the shade by inserting the stop pin into one of the aligned holes and push into place. The stop pin will prevent the shade from losing its set position.

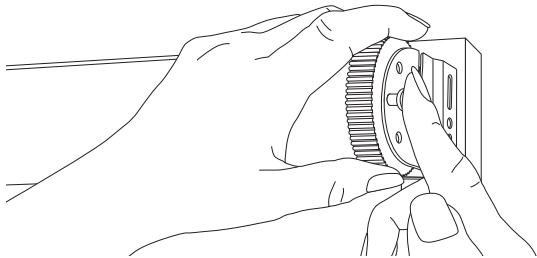

Inserting the stop pin

STEP 7 - INSTALL THE BRACKET COVERS.

The bracket covers are universal, and can be used on either side.

Simply snap onto the brackets for a clean, professional, finished look! You are done!

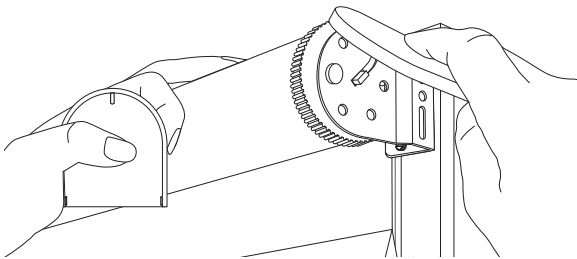

Inserting the right side bracket cover

Operating your Smartroll Shades

Unlike the typical spring shade, a Smartroll shade requires a minimal 1/4" tug. No need to pull hard or long. A gentle tug will do the trick!

It will rise and stop to the exact location set in STEP 4. No more fly-away shade that will bang against the window!

No cords or hazardous chains. Trouble-free and secure use.

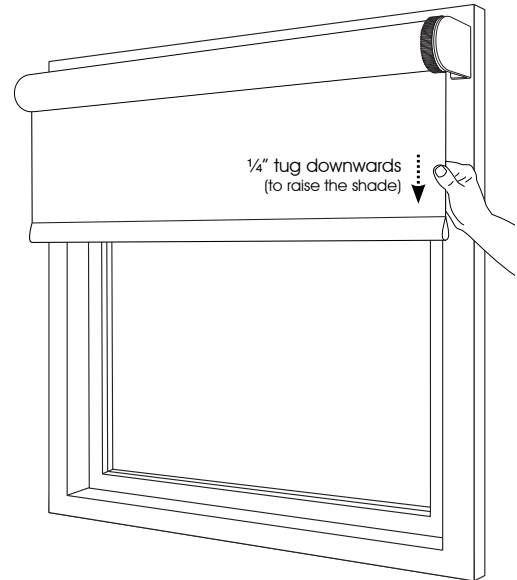

Caring for your Smartroll Shades

Your Smartroll shades will provide you with years of beauty and pleasure with minimal care and cleaning.

- Vacuum using a brush or dust head attachment.
- Dust lightly using a soft, clean cloth.
- Never immerse the shades in water or liquids of any type.

Call us at 800.828.2500 if you have any questions.