

INSTALLATION INSTRUCTIONS



Panels and Valances on Curtain Rods

Panels and Valances on Curtain Rods

Installation Instructions

Thank you for purchasing your new panels or valance. They have been custom-made from the highest quality materials to the dimensions you specified. With proper installation and care, they will provide you with many years of beauty and trouble-free use.

Please read all applicable instructions before you start so you will be familiar with the overall process.

Tools Required

- Power drill with the following bits:
 - 1/16" drill bit
 - 1/4" hex driver
 - Standard and Phillips screwdrivers
 - Masonry or metal drill bits (if mounting surface requires)
- Pencil
- Awl
- Tape measure
- Level
- Ladder or stepstool

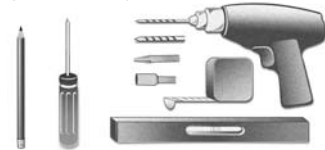

Hardware

- Curtain rod
- End brackets
- Center support (for wide valances)
- Screws
- Tie band hooks (for reverse hourglass)

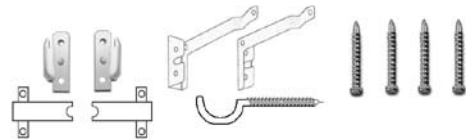

Special Fasteners

The brackets must be securely attached to the mounting surface. If wood studs are not available, use special fasteners designed for your mounting surface (not included). See illustration for examples.

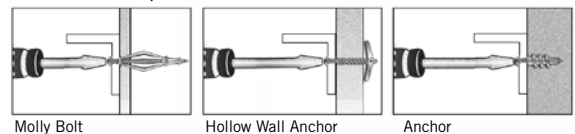

Tips

- If drilling into metal, purchase self-tapping screws.
- When selecting your fastener, make sure it is designed to support the weight of the product being installed. Follow the fastener manufacturer's instructions carefully.

Valances Mounted on Curtain Rods

Step 1: Place the Valance on the Curtain Rod

Feed the valance onto the curtain rod and extend the rod so the valance extends smoothly.



Step 2: Attach the Brackets to the Wall

Hold the valance in position and note the correct locations for the brackets.

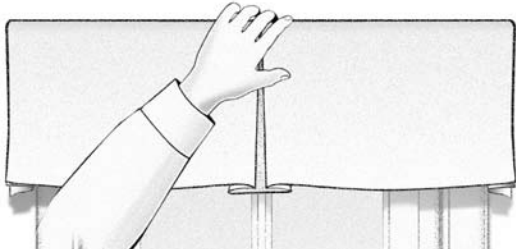

Measure and mark the positions of the brackets. Be sure the hooks or support arms are toward the outside, the brackets are level, and the distance between the hooks matches the face width of the valance.

Drill $\frac{1}{8}$ " pilot holes at the bracket mounting hole locations. Attach the brackets using the hex head screws provided.

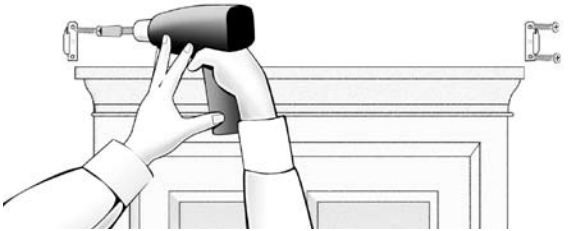
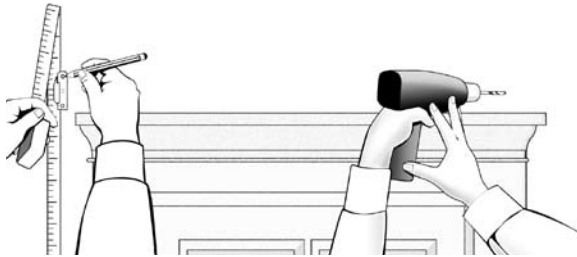

Step 3: Mount the Center Supports (if required)

If center supports are included (for wide valances only), measure and mark the support positions on the wall so that they will align with the openings in the rod pocket. Make the bottom of the supports level with the bottom of the bracket hooks or supports. Screw the supports into the wall up to the last thread with the opening facing upward.

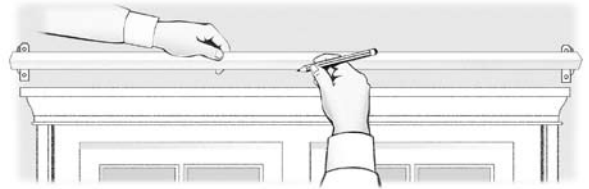

Step 4: Mount the Valance on the Brackets

For valances with 3" to 5" returns, place the rod on the brackets, rotate it upward so it catches the bracket hooks, and then rotate it down into position.

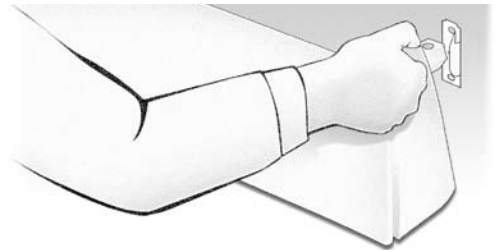

For valances with 6" to 8" returns, slide the ends of the rod over the bracket supports and push the rod into place against the brackets. Adjust the rod return to suit the depth of the valance.

Dress the valance and steam out any wrinkles as needed.

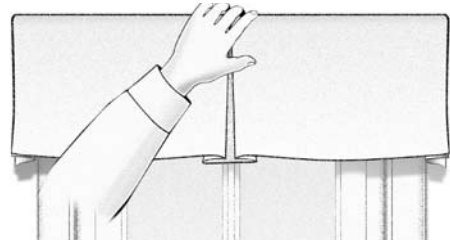
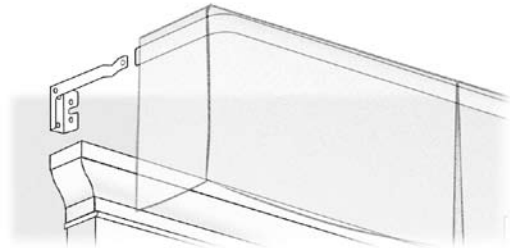

Rod Top and Bottom Panels

Step 1: Place the Panel on both the Top and the Bottom Rod

Join each rod by sliding the two halves together, using the plastic protector to cover the metal edge at the joint. Thread both the top and bottom rods into the rod pockets.

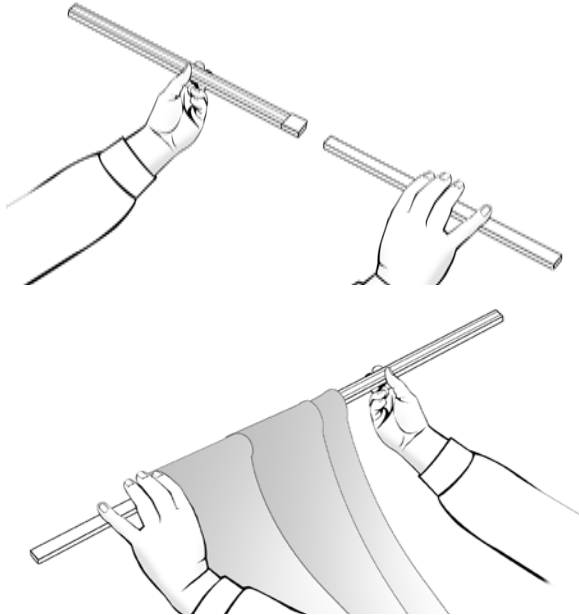

Step 2: Attach the Top Brackets

Hold the panel in place and note the correct placement of the rods. Position the top brackets in their correct locations with the tabs of the brackets facing in, and mark the locations. Use a level and measuring tape to ensure the brackets will be level and the rod centered over the window.

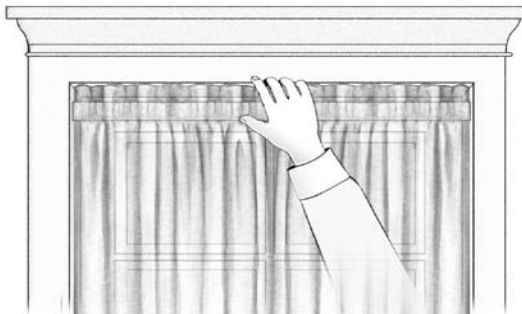

Drill $\frac{1}{16}$ " pilot holes at the mounting hole locations. Install the brackets using the screws provided.

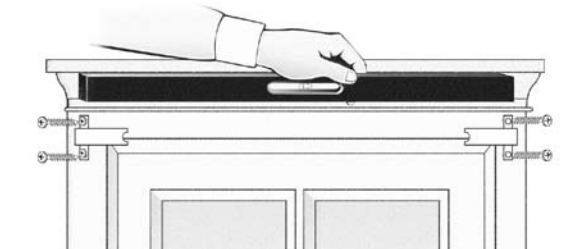
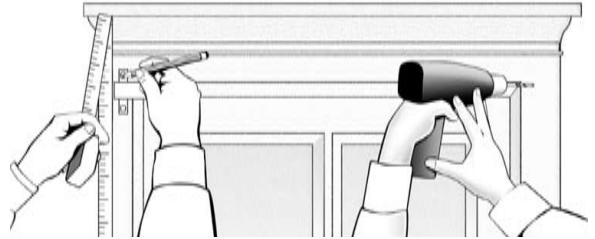

Step 3: Hang the Panel on the Top Brackets

Adjust the top rod so it is short enough to fit easily between the brackets. Push one end of the rod onto one of the brackets, holding the bracket with your other hand so as not to put too much strain on the bracket mount. Expand the rod and push the other end onto the other bracket in the same way.

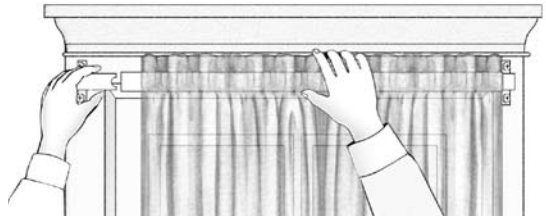

Step 4: Attach the Lower Brackets

Gently pull the bottom rod into its correct position and note the correct level for the bottom brackets. Measure and mark the locations for the brackets, making sure they are level with each other and aligned with the upper brackets.

Hold the brackets in place with the tabs facing in, and mark the positions of the mounting holes. Drill $\frac{1}{16}$ " pilot holes at the mounting hole locations. Install the brackets using the screws provided.

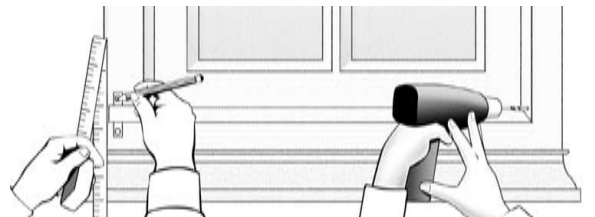

Step 5: Attach the Bottom Rod to the Brackets

Adjust the rod in the bottom of the panel so it is short enough to fit easily between the brackets. Push one end of the rod onto one of the brackets, holding the bracket with your other hand so as not to put too much strain on the bracket mount. Expand the rod and push the other end onto the other bracket in the same way.

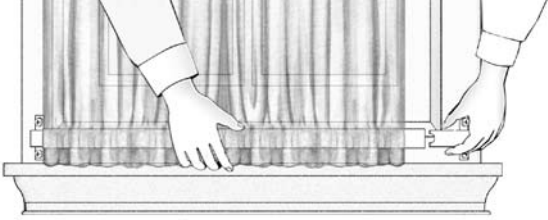

Step 6: Attach the Tie Bands (for Hourglass and Reverse Hourglass only)

Hourglass

Wrap the tie band around the center of the panel and thread the end through the D-rings.

Rotate the tie band on the panel so the D-rings face the window in the center. Dress the tie band and the panel so the tie band lies flat and the panel gathers gracefully into the tie band.

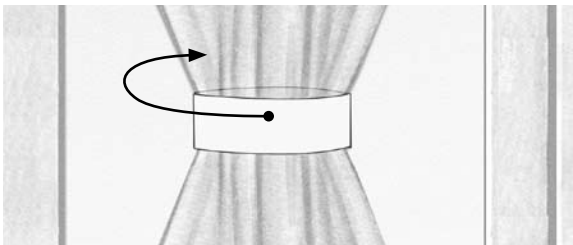
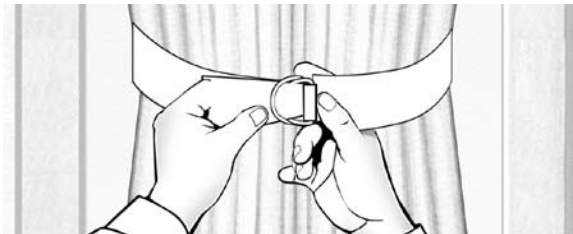
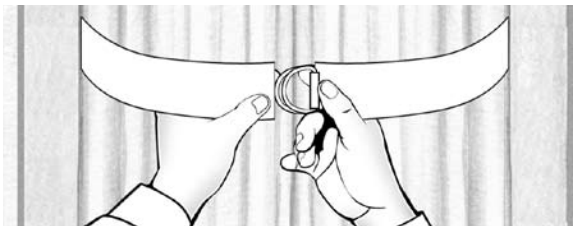

Reverse Hourglass

Measure and mark the correct positions for the tie band hooks, making sure they are vertically centered in the window and level with each other.

Drill $\frac{1}{16}$ " pilot holes at the marked locations. Install the tie band hooks by screwing them into the door or window frame.

Attach each tie band by placing the tie band ring that extends past the end of the tie band on the hook and looping the tie band around the panel from behind. Then place the other ring of the tie band over the hook. Dress the tie bands and the panels so the panels gather gracefully into the tie bands.

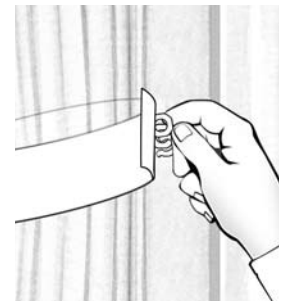
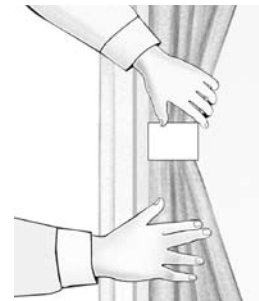
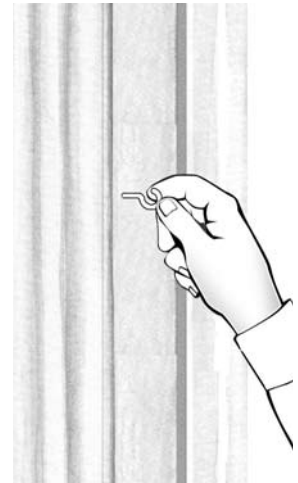
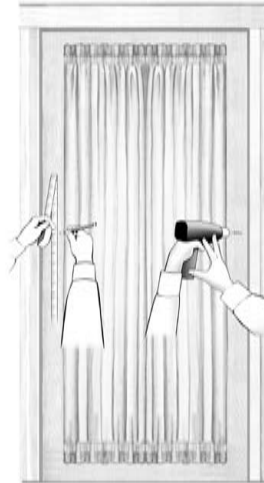

Caring for Your Valance or Panels

These valances and panels will provide you with years of beauty and pleasure with minimal care and cleaning. To care for your treatments:

- Vacuum using a brush or dust head attachment.
- Dust lightly using a soft, clean cloth.
- Dry clean if they need a more thorough cleaning.
- Never immerse your valances or panels in water or liquids of any kind.