

L-SYSTEMS BEAD CHAINS

INSTALLATION INSTRUCTIONS

HOW TO CHANGE OUT THE L-SYSTEMS CLUTCH BEAD CHAINS

(for the L32, L40, L40 PLUS and L45, L45 PLUS CLUTCH SYSTEMS)



L-SYSTEMS BEAD CHAINS

INSTRUCTIONS ON CHANGING OUT THE BEAD CHAIN ON OUR L-SYSTEM CLUTCHES.

Thank you for purchasing our new L-System Clutches. They have been custom-made from the highest quality materials to the dimensions you specified. With the proper installation and care, it will provide you with many years of beauty and trouble-free use.

Our L-System Clutches come with the bead chains pre-installed. If you need to change out the bead chains, please read all instructions below before you start, so you will be familiar with the overall process.

Getting Started

TOOLS REQUIRED

A small Phillips head screwdriver.

BEFORE YOU BEGIN, VERIFY THAT YOU HAVE ALL THE NECESSARY PARTS AND PIECES:

- **PACKAGE** - Your package will contain the new bead chains, connectors and stoppers.

OPTION 1 - CHANGING THE BEAD CHAIN WITH THE ROLLER SHADE OUT OFF THE BRACKETS.

STEP 1 - REMOVE THE ROLLER SHADE.

Take the roller shade off the brackets.

STEP 2 - CHANGE OUT THE BEAD CHAIN.

- a) Remove the clutch assembly from the roller shade. See illustration below.

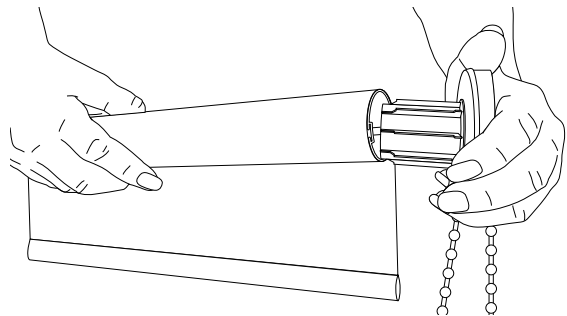

STEP 2 - CHANGE OUT THE BEAD CHAIN (CONTINUED).

b) Remove the black lock button.

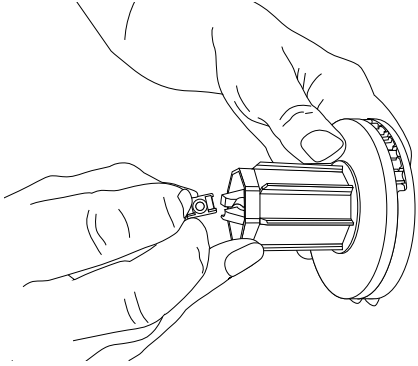

c) Depress the red tips and push inwards.

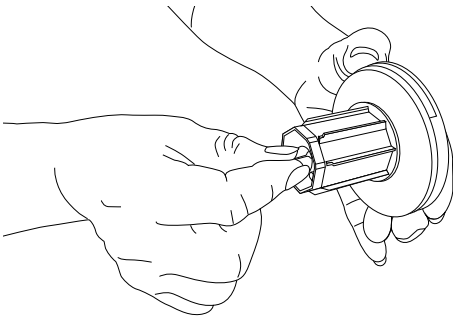

d) Open up the sprocket cage.

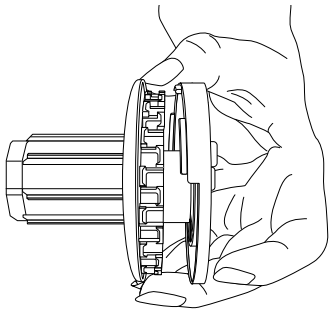

←..... →
pull sprocket apart

STEP 2 - CHANGE OUT THE BEAD CHAIN (CONTINUED).

e) Remove the old bead chain.

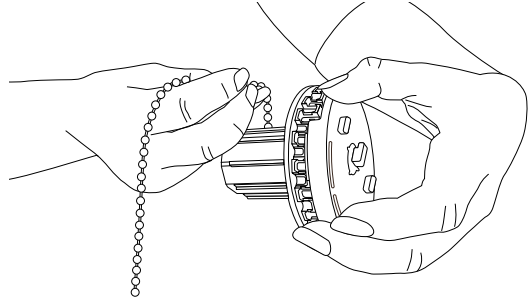

f) Place the new chain, making sure that the beads fit properly in the sprocket wheel.

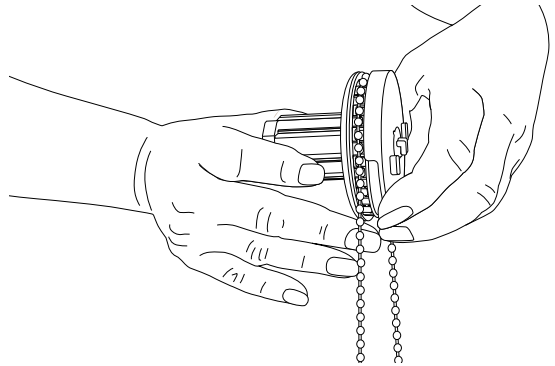

g) Shut sprocket cage.

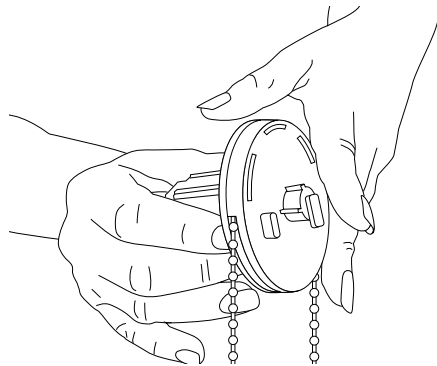

STEP 2 - CHANGE OUT THE BEAD CHAIN (CONTINUED).

h) Push the red or blue bracket pin in.

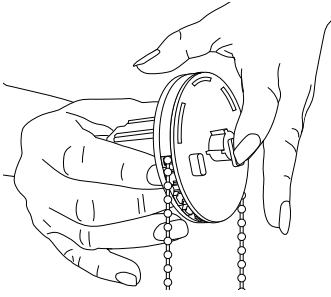

i) Replace the black lock pin.

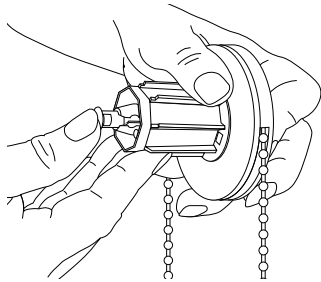

j) Push clutch back into the roller tube. Make sure the clutch key drives align with the roller tube drives.

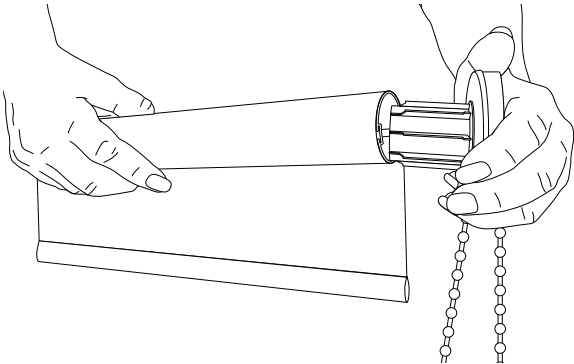

k) Reset your long points. Attach the connectors, and then reset the stops.

l) Attach the roller shade into the brackets.

m) DO NOT FORGET TO INSTALL THE P-CLIP HOLDDOWN.

OPTION 2 - CHANGING THE BEAD CHAIN WITH THE ROLLER SHADE INSTALLED ON THE BRACKETS.

STEP 1 - ROLLER SHADE, CLUTCH AND CHAIN.

Leave the roller shade, clutch and chain on the brackets.

STEP 2 - CHANGE OUT THE BEAD CHAIN.

a) Open the connector and stop, and remove.

b) Carefully pull the old chain down and out of the clutch.

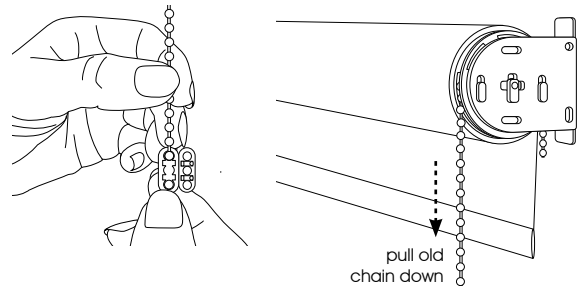

c) Place the new replacement chain on the sprocket. See drawing below.

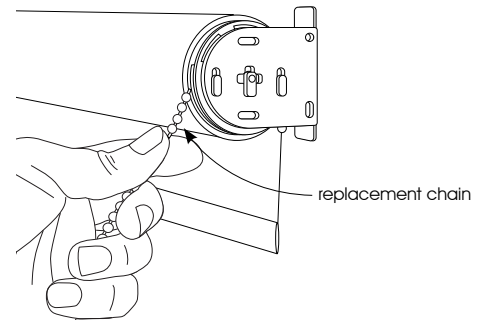

d) Using a small screwdriver, rotate the sprocket until the new chain comes out the back of the clutch.

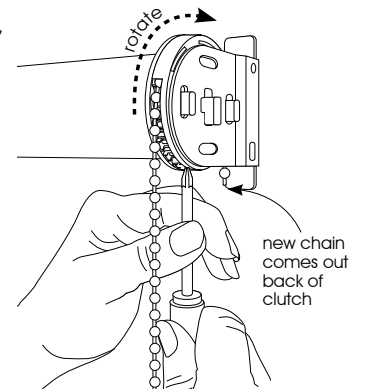

STEP 2 - CHANGE OUT THE BEAD CHAIN (CONTINUED).

e) Wrap the shade around the roller tube until the bottom hem is at the top of the roll. Note: It may be necessary to pull the chain in order to properly align the shade.

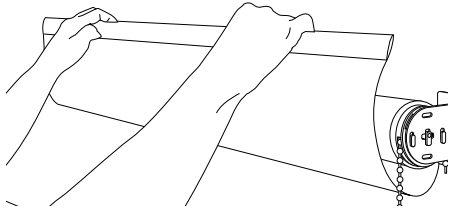

f) Very important! Trim the cord/bead chain as close to the clutch as shown. This will be the upper limit of the shade.

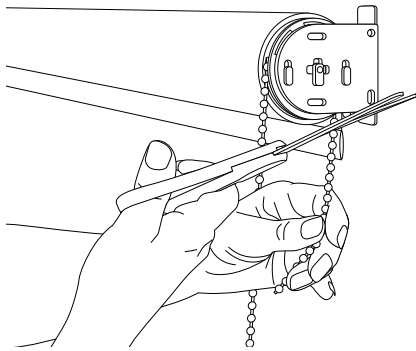

g) Replace the connector. Make sure the bottom of shade aligns with connector.

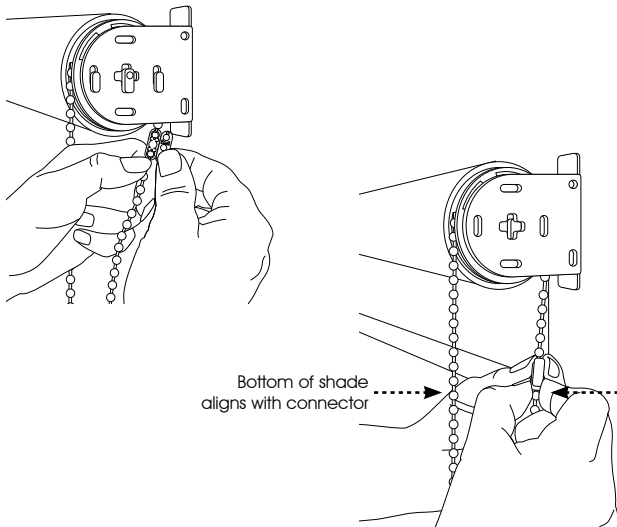

STEP 2 - CHANGE OUT THE BEAD CHAIN (CONTINUED).

h) Set the lower limit/stop position. Lower the shade to the desired long point. Pinch the bead chain at this point on the front of the clutch, and place one of the bead chain stops here.

One extra bead chain stop is provided in case a change must be made.

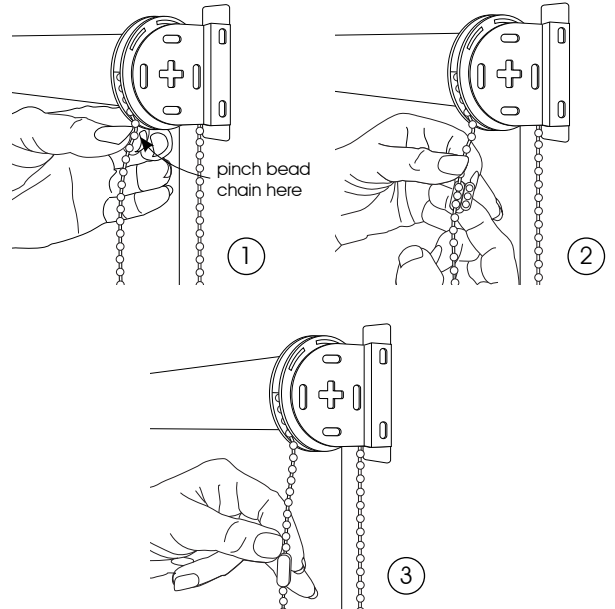

i) DO NOT FORGET TO INSTALL THE P-CLIP HOLDDOWN.

Caring for your Clutches, Bead Chains & Roller shades

Your clutches, bead chains and roller shades will provide you with years of beauty and pleasure with minimal care and cleaning.

- Vacuum using a brush or dust head attachment.
- Dust lightly using a soft, clean cloth.
- Never immerse the clutches or shades in water or liquids of any type.

Call us at 800.828.2500 if you have any questions.