

# Fabrication Instructions ~ System II

## Roller Shades and Solar Screens

### Required Components

- A) Tubular Motor Assembly
- B) 6 AA Battery Pack or Optional Battery Wand
- C) Tube Crown /Drive/ Screw & Washer

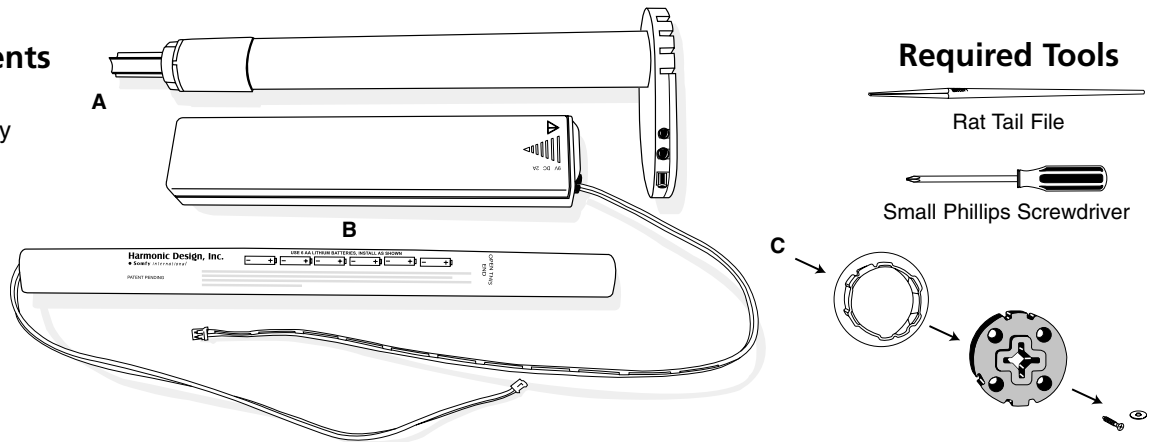

### Required Tools

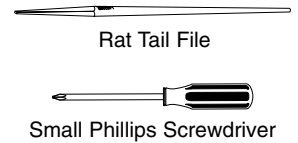

**Optional Motor Rotation** Motor comes standard as a right side motor. To change the motor to a left side motor:

a. Remove roller shade insert / plug

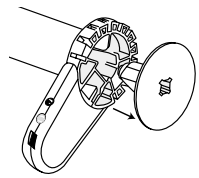

b. Slide tear drop out of housing

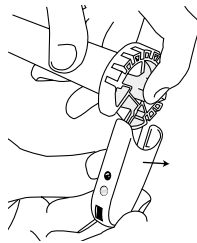

c. Rotate tear drop 180°

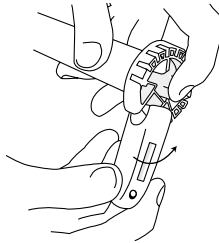

d. Slide back into housing

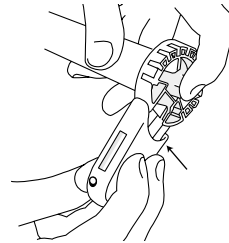

e. Replace insert / plug

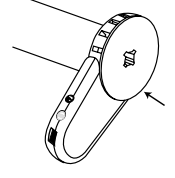

**CAUTION:** Excessive force during rotation may detach internal connector. If this happens carefully use a small screwdriver and press connector housing to reinsert.

### Step 1

Place tube crown over motor with the flat side of the crown placed flush against the motor housing.

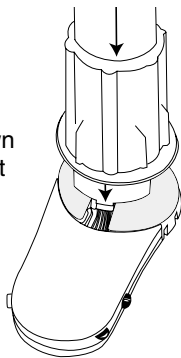

### Step 2

Using phillips screwdriver, attach enclosed screw and washer to the drive and motor shaft.

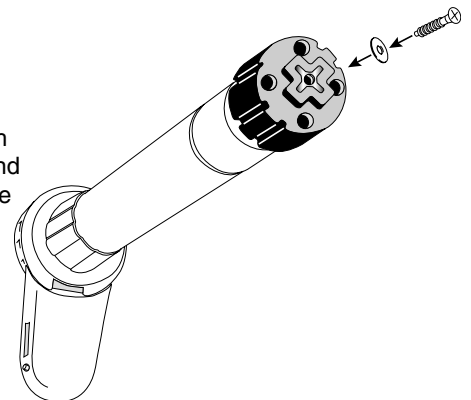

### Step 3

Debur the inside of the tube using the rat tail file.

The shade is now ready for final assembly.

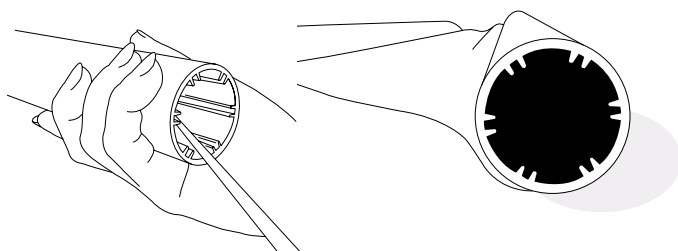

### Step 4

Slide motor into tube firmly. Crown and drive must be properly aligned with tube profile.

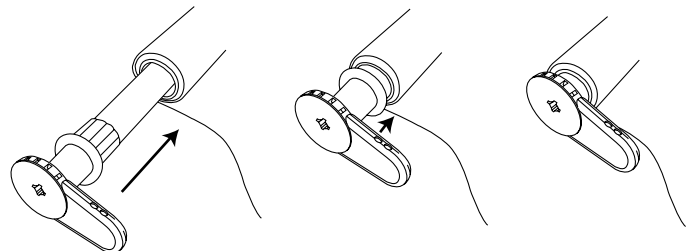

Roller tube must be aluminum. Motor will not operate when used with steel tube.